

KUVN- 8
KUVN-12
KUVN-16
KUVN-21

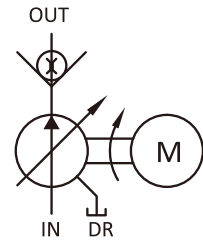
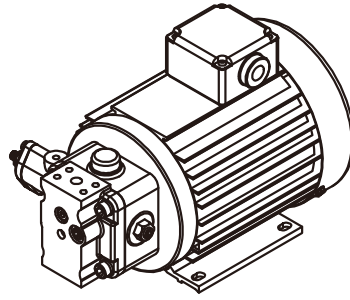

SYMBOL

Features 特點

- ❖ Energy efficient high performance up 30~40%(高效高性能)
- ❖ Lightweight, compact design (重量輕, 結構緊湊)
- ❖ Low noise, long life (低噪音, 壽命長)
- ❖ Low heat generation, low temperature rise(低發熱, 低溫升)

Model	Capacity (cm ³ /rev)	Operating Pressure Mpa (kgf/cm ²)	No-load discharge Rate (L/min)		Input power (HP)	Net Weight (Kg)
			50HZ	60HZ		
KUVN-8-A(B)-2-* -4-A-10	8	1.5~ 4.0(15.3~40.8)	12	14.4	1~2	1HP:22 2HP:29 3HP:38.5 5HP:45
KUVN-8-A(B)-3-* -4-A-10		3.5~ 6.0 (35.7~61.2)				
KUVN-8-A(B)-4-* -4-A-10		5.5~ 8.0 (56.1~81.6)				
KUVN-12-A(B)-2-* -4-A-10	12	1.5~ 4.0(15.3~40.8)	18	21.6	1~2	
KUVN-12-A(B)-3-* -4-A-10		3.5~ 6.0 (35.7~61.2)			2~3	
KUVN-12-A(B)-4-* -4-A-10		5.5~ 8.0 (56.1~81.6)			2~3	
KUVN-16-A(B)-2-* -4-A-10	16	1.5~ 4.0(15.3~40.8)	24	28.8	2~3	
KUVN-16-A(B)-3-* -4-A-10		3.5~ 6.0 (35.7~61.2)			2~3	
KUVN-16-A(B)-4-* -4-A-10		5.5~ 8.0 (56.1~81.6)			3~5	
KUVN-21-A(B)-2-* -4-A-10	21	1.5~ 4.0(15.3~40.8)	31.5	37.8	2~3	
KUVN-21-A(B)-3-* -4-A-10		3.5~ 6.0 (35.7~61.2)			3~5	
KUVN-21-A(B)-4-* -4-A-10		5.5~ 8.0 (56.1~81.6)			3~5	

Ordering Code 訂購指引

KUVN - 8 - A - 3 - 1 - 22 - 1 - 4 - A

① ② ③ ④ ⑤ ⑥ ⑦ ⑧ ⑨

- | | |
|---|---|
| <p>① KUVN Series Uni-pump</p> <p>② Displacement (cm³/rev) : 8 , 12 , 16 , 21</p> <p>③ A : Motor-Side leak-proof(馬達端防漏型)
B : Pump-Side leak-proof(泵軸端防漏型)</p> <p>④ Pressure adjustment range
2 : 15 ~ 40 (kgf/cm²)
3 : 35 ~ 61 (kgf/cm²)
4 : 56 ~ 80 (kgf/cm²)</p> <p>⑤ Shaft Type
1 : 長鍵 2 : 一字鍵 3 : Splined
*參見 KVDN 外型尺寸說明。</p> | <p>⑥ Motor Voltage (Volt)
22 : AC-220V
38 : AC-380V
44 : AC-440V</p> <p>⑦ Motor Output (Kw)
1 : 0.75 Kw
2 : 1.50 Kw
3 : 2.20 Kw</p> <p>⑧ Number of motor poles 4P</p> <p>⑨ Type of Suction Port & Discharge Port
A or No : RC C : SAE
B : NPT D : BSP</p> |
|---|---|

KUVN-8
KUVN-12
KUVN-16
KUVN-21

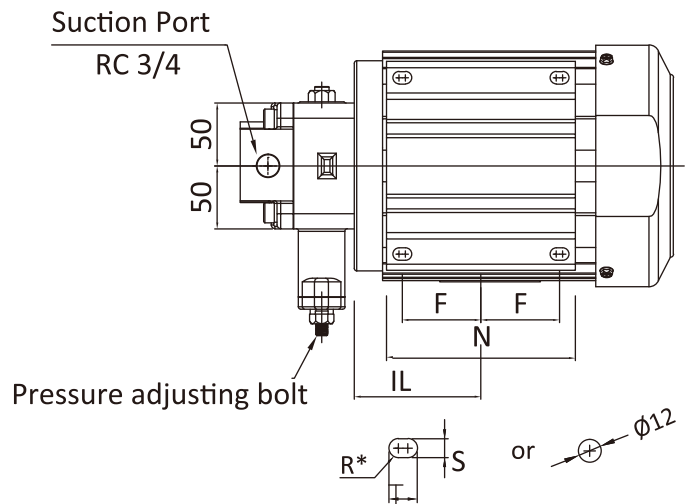
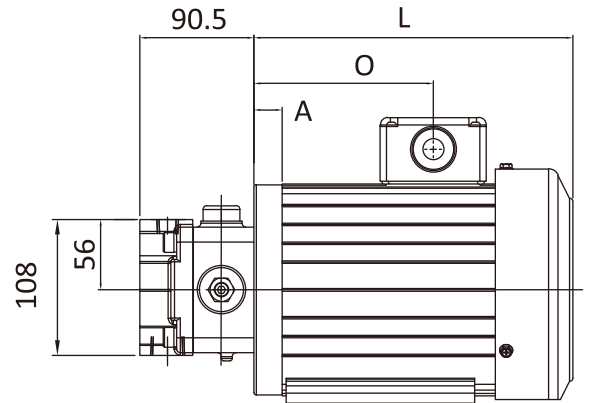
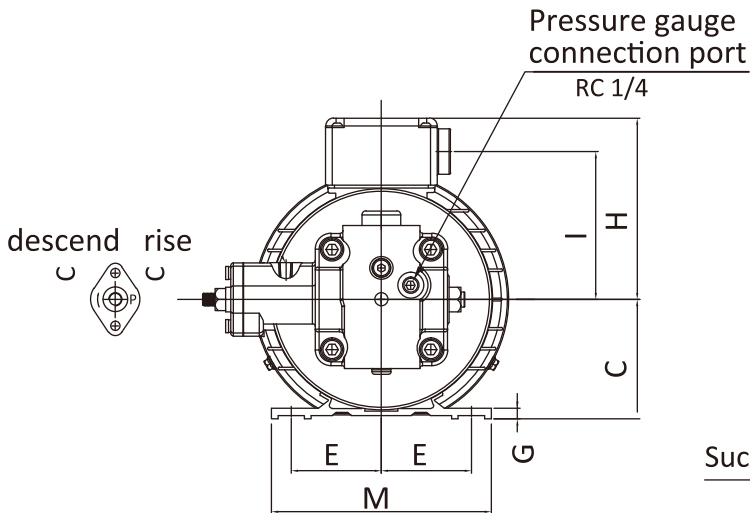
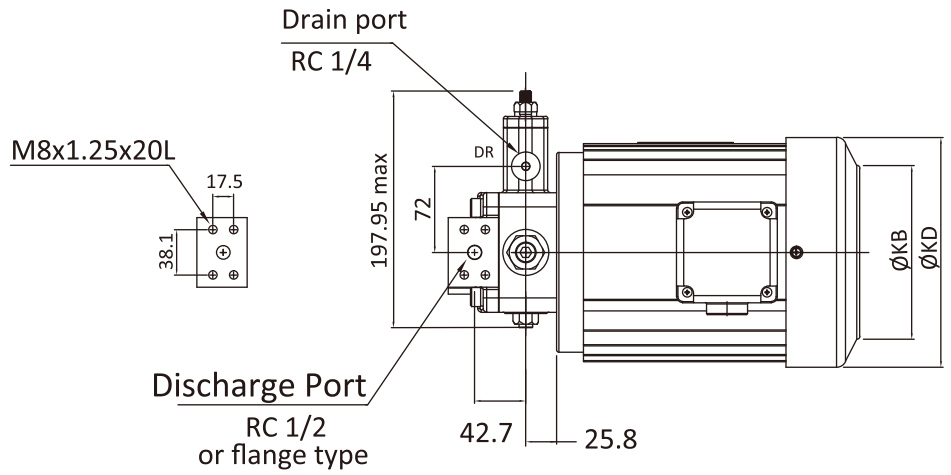

Model No		Motor Dimensions mm (mm)															
		A	C	E	F	G	H	I	L	M	N	O	S x T	IL	KB	KD	R*/Ø
KUVN*-A*-1-4	1.5 - 4 2HP	23	90	70	62.5	8	135	107	253.5	166	150	143	15 x 10	100.5	Ø147	Ø184	R6
KUVN*-A*-2-4	2.2 - 4 3HP	25	100	80	70	10	147	119	278.5	195	180	155	Ø12	110	Ø167	Ø205.4	Ø12